

B16FD-UBU

PN16

DN700~1200

SPECIFICATION

UNIVERSAL TYPE · FLANGED TO BS 4504 PN16
CONFORMS TO MSS SP-67-1995 / API 609-91
DOUBLE STAGE WORM GEAR OPERATOR

PRESSURE / TEMPERATURE RATINGS

Working Pressure	16 bar
Testing Pressure	Shell : 24 bar Seat : 17.6 bar
Working Temperature	-20 °C to 110 °C (EPDM Seat) -10 °C to 80 °C (NBR Seat)
Suitable Media	Water, Oil & Gas

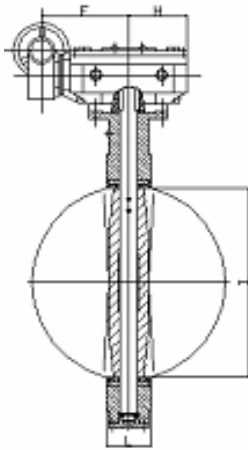
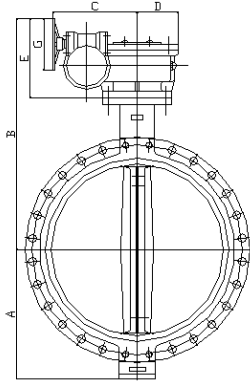

MATERIALS

Part	Material	BS
Body	Ductile Iron	Gr. 420/12
Disc	Ductile Iron Aluminum Bronze Stainless Steel 304 Stainless Steel 316	Gr. 420/12 1400 AB2 304 C15 316 C16
Seat Ring	EPDM NBR Viton	
Shaft	Stainless Steel 410 Stainless Steel 431 Stainless Steel 316	410 S21 431 S29 316 S16
Taper Pins	Stainless Steel 316	316 S16
Key	Carbon Steel	
O-Ring	NBR	
Bushing	Luberized Bronze	

DIMENSIONS

Size mm	A mm	B mm	C mm	D mm	E mm	F mm	G mm	H mm	I mm	L Mm	Cv 90°
700	624	902	357	173	382	243	435	173	675	165	49500
750	560	1042	357	173	382	243	435	173	725	167	73426
800	608	1048	357	173	382	243	435	173	773	190	78250
900	656	1196	410	201	476	278	435	201	840	203	87500
1000	800	1197	410	201	476	278	435	201	940	218	119750
1050	777	1334	410	201	476	278	435	201	999	251	121000
1200	864	1468	509	214	528	458	435	310	1126	276	154000

Note:

1. Design and specifications are subject to change without prior notice.
2. Other specifications and flange standards are available upon request.
3. Actuator mounting flange conforms to ISO 5211 drilling.
4. The butterfly valve can be supplied with electric or pneumatic actuator.