

A125WC-RCH A250WC-RCH

SPECIFICATION

FOR ANSI CLASS 125 / CLASS 250 FLANGE MOUNTING

Class 125
Class 250
2"~10"



PRESSURE / TEMPERATURE RATINGS

Class	Class 125	Class 250
Working Pressure	200 psi	350 psi
Testing Pressure	Shell : 350 psi Seat : 220 psi	Shell : 525 psi Seat : 385 psi
Working Temperature	14 °F to 248 °F	
Suitable Media	Water, Oil & Gas	

MATERIALS

Part	Material	ASTM
Body	Cast Iron	A125 Class B
Disc	Gunmetal	B62 C83600
Spring	Stainless Steel	AISI 304
Bushing	Gunmetal	B62 C83600
Seat	Gunmetal	B62 C83600

DIMENSIONS

Size inch	L inch	D inch
2	2.6	4.4
2-1/2	2.9	5
3	3.1	5.7
4	4	7.4
5	4.6	8.4
6	5.5	9.8
8	6.5	13.4
10	8.5	16.1

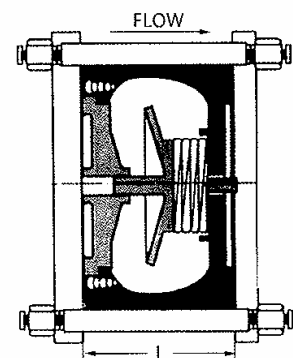
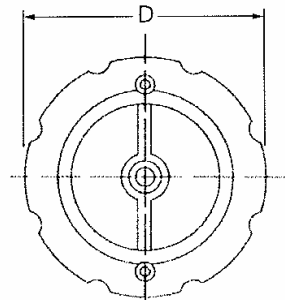

Note:

1. Other specifications and flange standards are available upon request.
2. Design and specifications are subject to change without prior notice.